

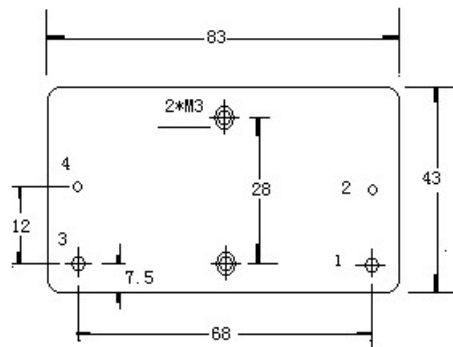

### Specification Crystal Filter 100kHz

P/N: 100K24C

Item	Typical
Nominal Frequency (kHz)	100
Insertion Loss (dB)	4.5
Ripple within Pass band (dB)	1.0
Bandwidth at -3dB (Hz)	$\pm 12$
Stop Band Rejection (dB), $f_0 \pm 120$ Hz	60
I/O Impedance ( $\Omega$ )	1500/1500
Operation Temperature ( $^{\circ}\text{C}$ )	-5 ~ +60
Package Size (mm)	83*43*24



1输入 3输出

2 4地线